



N 226 ECP

- Popular item
- SKF Explorer

Cylindrical roller bearings, single row

Bearing data

[Tolerances](#),
Normal (metric), P6, Normal (inch),
[Radial internal clearance](#),
cylindrical bore, tapered bore,
[Axial internal clearance](#),
NUP, NJ + HJ

Bearing interfaces

[Seat tolerances for standard conditions](#),
[Tolerances and resultant fit](#)

Technical specification

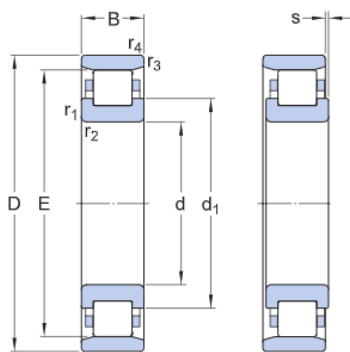

DIMENSIONS

d	130 mm	Bore diameter
D	230 mm	Outside diameter
B	40 mm	Width
d1	≈164 mm	Shoulder diameter of inner ring
E	209.5 mm	Raceway diameter of outer ring
r1,2	min.3 mm	Chamfer dimension
r3,4	min.3 mm	Chamfer dimension
s	max.2.1 mm	Permissible axial displacement

ABUTMENT DIMENSIONS

da	min.144 mm	Diameter of spacer sleeve
da	max.206 mm	Diameter of spacer sleeve
Da	min.213 mm	Diameter of housing abutment
Da	max.217 mm	Diameter of housing abutment
	max.2.5	Radius of

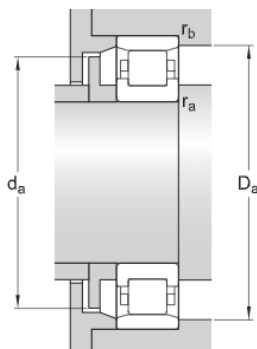

ra	mm	fillet
rb	max.2.5 mm	Radius of fillet

CALCULATION DATA

Basic dynamic load rating	C	415 kN
Basic static load rating	C ₀	455 kN
Fatigue load limit	P _u	51 kN
Reference speed		3 200 r/min
Limiting speed		3 400 r/min
Minimum load factor	k _r	0.12
Limiting value	e	0.2
Axial load factor	Y	0.6

MASS

Mass		6.43 kg
------	--	---------